

| Rev | Description | Date |
|-----|-------------|------|
| | | |
| | | |
| | | |
| | | |

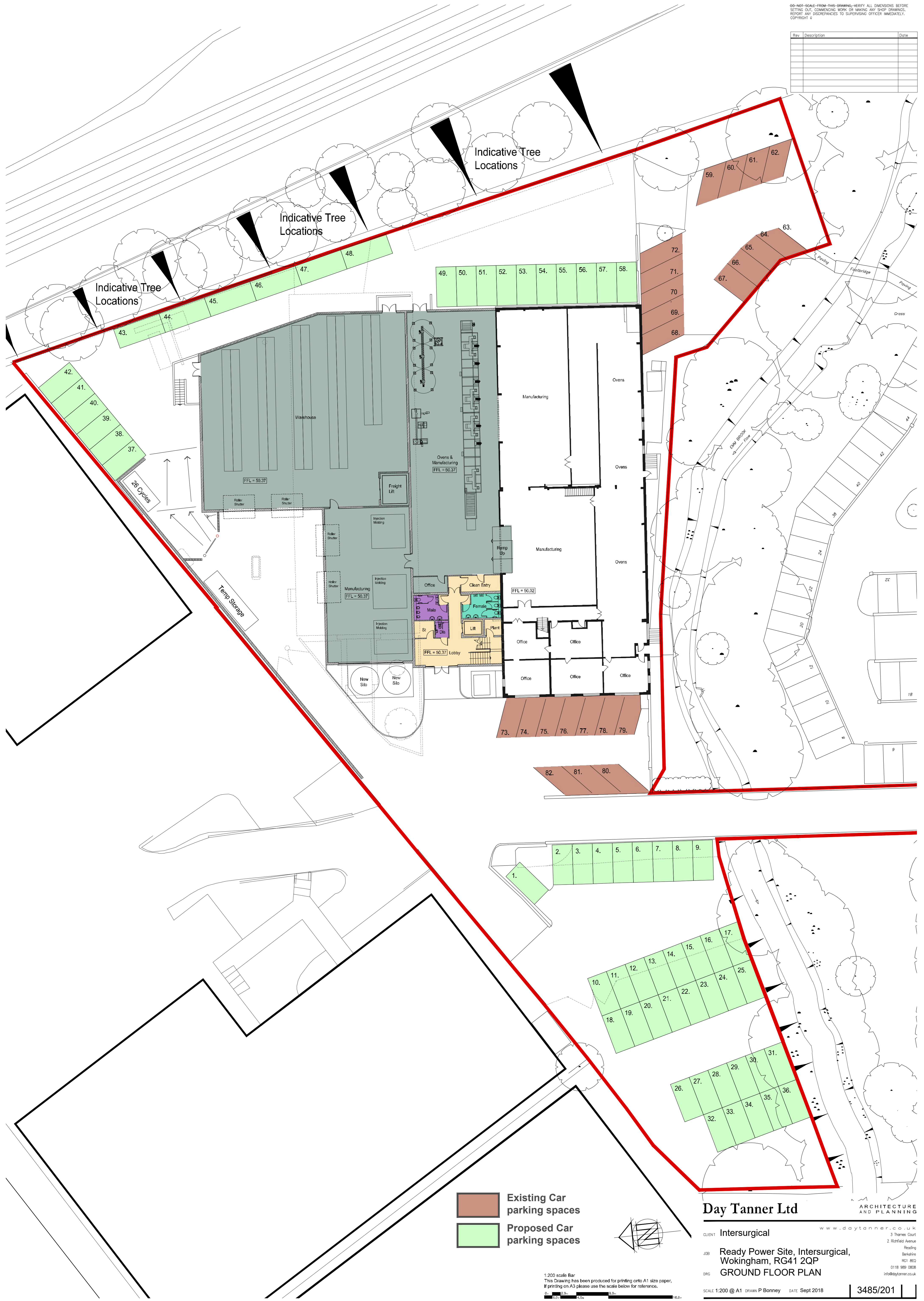

Existing Car parking spaces
Proposed Car parking spaces

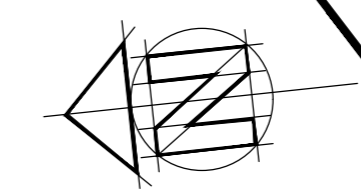

1:200 scale Bar
This Drawing has been produced for printing onto A1 size paper.
If printing on A3 please use the scale below for reference.

Day Tanner Ltd ARCHITECTURE AND PLANNING
www.daytanner.co.uk

CLIENT Intersurgical
3 Thames Court
2 Moorfields Avenue
Reading
Berkshire
RG1 8EQ
0118 989 0806
info@daytanner.co.uk

JOB Ready Power Site, Intersurgical, Wokingham, RG41 2QP
DRC GROUND FLOOR PLAN

SCALE 1:200 @ A1 DRAWN P Bonney DATE Sept 2018 3485/201

This page is intentionally left blank